

# HoldenCopley

PREPARE TO BE MOVED

Green Lane, Clifton, Nottinghamshire NG11 9AX

---

Guide Price £160,000 - £170,000

Green Lane, Clifton, Nottinghamshire NG11 9AX





GUIDE PRICE: £160,000 - £170,000

WELL PRESENTED FIRST TIME OR FAMILY HOME...

This three bedroom terraced house is the perfect purchase for any first time or family buyer as it offers spacious accommodation whilst being well presented and has great potential. Situated on a popular road, less than a five minute walk to various shops, excellent bus links and local amenities. To the ground floor is an entrance hall with a W/C, a spacious lounge diner and a modern kitchen. The first floor carries three good sized bedrooms serviced by a shower room suite. Outside there are generous sized gardens to the front and rear of the property along with an outhouse building. This property benefits from having plenty of storage space and off road parking.

MUST BE VIEWED







- Terraced House
- Three Bedrooms
- Spacious Lounge Diner
- Modern Kitchen
- Ground Floor W/C
- Shower Room Suite
- Plenty Of Storage Space
- Generous Sized Gardens
- Close To Local Amenities
- Must Be Viewed











GROUND FLOOR

Entrance Hall

The entrance hall has tiled flooring, a wall mounted thermostat, a UPVC double glazed frosted glass window, a radiator, carpeted stairs and provides access into the accommodation

W/C

This space has a low level flush WC, floor to ceiling tiles and a UPVC double glazed window

Kitchen

9'3" x 13'8" (2.83 x 4.19)

The kitchen has a range of base and wall units with rolled edge worktops, a stainless steel sink and a half with mixer taps and drainer, an integrated oven, a gas hob with an extractor fan, space and plumbing for a washing machine, an under stair pantry cupboard, tiled splash back, tiled flooring, a radiator, a UPVC double glazed window to the rear elevation and a single door providing access to the garden

Lounge / Diner

11'1" x 19'7" (3.38 x 5.99)

The lounge diner has a UPVC double glazed window to the front and rear elevation, a TV point, coving to the ceiling, tiled flooring, a recessed chimney breast with a feature fireplace and a solid wood mantelpiece, two radiators and a single french door providing access to the garden

FIRST FLOOR

Landing

The landing has carpeted flooring, a loft hatch, two built in cupboards and provides access to the first floor accommodation

Bedroom One

11'4" x 10'11" (3.47 x 3.35)

The main bedroom has a UPVC double glazed bay window to the front elevation, carpeted flooring and a built in cupboard

Bedroom Two

8'5" x 10'10" (2.59 x 3.31)

The second bedroom has a UPVC double glazed window to the front elevation, a radiator, stripped wooden flooring and fitted wardrobes with over the bed storage units

Bedroom Three

13'9" x 8'6" (4.20 x 2.61)

The third bedroom has a UPVC double glazed window to the rear elevation, carpeted flooring, a radiator and a built in cupboard

Shower Room

6'4" x 5'4" (1.94 x 1.63)

This space has a floating wash basin, a walk in shower enclosure, floor to ceiling tiles, a radiator and a UPVC double glazed window to the rear elevation

OUTSIDE

Front

To the front of the property is a gravelled garden with hedged borders

Rear

To the rear of the property is a private enclosed garden with a paved pathway, a laid lawn, an outhouse building, outdoor lighting and fence panelling

Outbuilding

DISCLAIMER

Agents Disclaimer: HoldenCopley, their clients and employees I: Are not authorised to make or give any representations or warranties in relation to the property either here or elsewhere, either on their own behalf or on behalf of their client or otherwise. They assume no responsibility for any statement that may be made in these particulars. These particulars do not form part of any offer or contract and must not be relied upon as statements or representations of fact. 2: Any areas, measurements or distances are approximate. The text, photographs and plans are for guidance only and are not necessarily comprehensive. It should not be assumed that the property has all necessary planning, building regulation or other consents and HoldenCopley have not tested any services, equipment or facilities. Purchasers must make further investigations and inspections before entering into any agreement.

Purchaser information -The Money Laundering, Terrorist Financing and Transfer of Funds(Information on the Payer) Regulations 2017(MLR 2017) came into force on 26 June 2017. HoldenCopley require any successful purchasers proceeding with a property to provide two forms of identification i.e. passport or photocard driving license and a recent utility bill or bank statement. We are also required to obtain proof of funds and provide evidence of where the funds originated from. This evidence will be required prior to HoldenCopley removing a property from the market and instructing solicitors for your purchase.

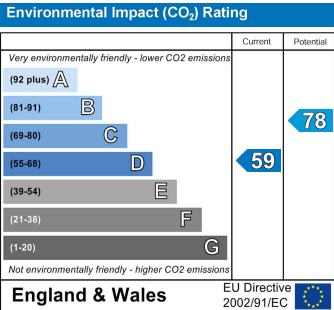
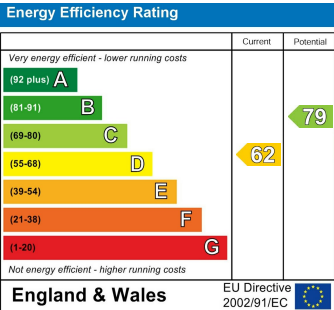

# Green Lane, Clifton, Nottinghamshire NG11 9AX

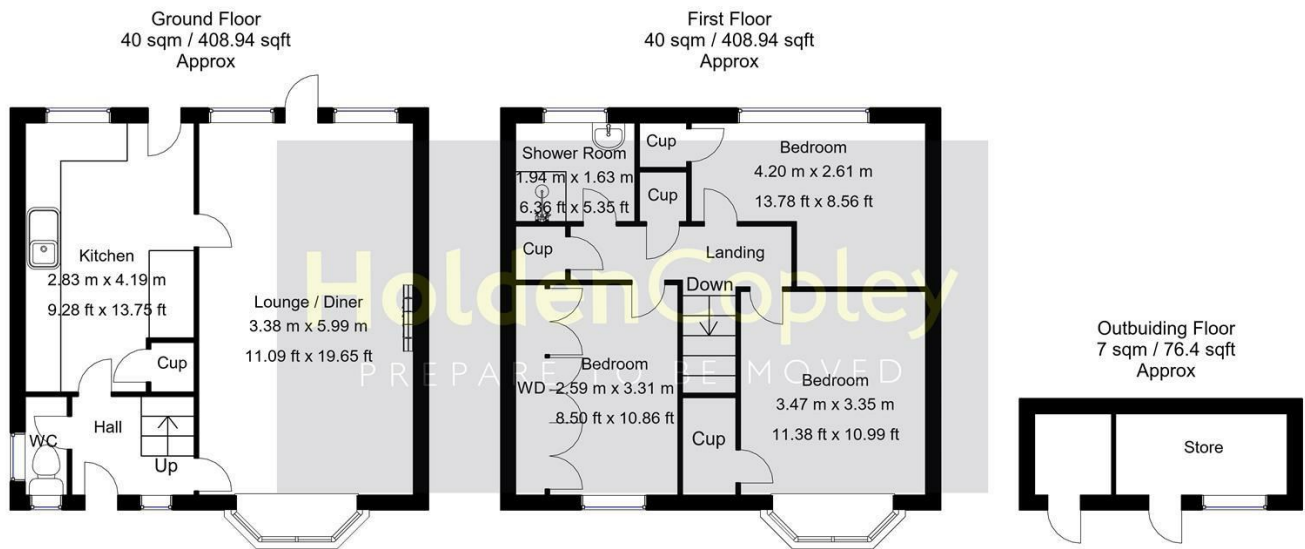

Whilst every attempt has been made to ensure the accuracy of the floor plan contained here, no responsibility is taken for incorrect measurements of doors, windows, appliances and room or any error, omission or misstatement. Exterior and interior walls are drawn to scale based on interior measurements. Any figure given is for initial guidance only and should not be relied on as basis of valuation. These plans are for marketing purposes only and should be used as such by any prospective purchase. Specially no guarantee is should not be relied on as a basis of valuation. These plans are for marketing purposes only and should be used as such by any prospective purchase. Specially no guarantee is given on the total square footage of the property if quoted on this plan.  
CC Ltd ©2018

01156712555

2 Tudor Square, West Bridgford, Nottingham, NG2 6BT

[www.holdencopley.co.uk](http://www.holdencopley.co.uk)

Agents Disclaimer: HoldenCopley, their clients and employees I: Are not authorised to make or give any representations or warranties in relation to the property either here or elsewhere, either on their own behalf or on behalf of their client or otherwise. They assume no responsibility for any statement that may be made in these particulars. These particulars do not form part of any offer or contract and must not be relied upon as statements or representations of fact. 2: Any areas, measurements or distances are approximate. The text, photographs and plans are for guidance only and are not necessarily comprehensive. It should not be assumed that the property has all necessary planning, building regulation or other consents and HoldenCopley have not tested any services, equipment or facilities. Purchasers must make further investigations and inspections before entering into any agreement.